

## HSSE-Viertelrund-Profilfräser, konkav

HSSE corner rounding profile cutters, concave

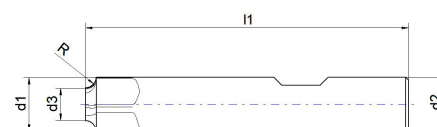

Artikelnummer Article-No.	d1 js15	R H11	d3	l1	d2 h6	Zähne
E.9625.0.0100	8	1	6	60	10,0	4
E.9625.0.0150	9	1.5	6	60	10,0	4
E.9625.0.0200	10	2	6	60	10,0	4
E.9625.0.0250	11	2.5	6	60	10,0	4
E.9625.0.0300	12	3	6	60	12,0	4
E.9625.0.0350	13	3.5	6	60	12,0	4
E.9625.0.0400	14	4	6	60	12,0	4
E.9625.0.0450	15	4.5	6	60	12,0	4
E.9625.0.0500	16	5	6	60	12,0	4
E.9625.0.0600	20	6	8	67	16,0	4
E.9625.0.0700	22	7	8	71	16,0	4
E.9625.0.0750	23	7.5	8	71	16,0	4
E.9625.0.0800	24	8	8	71	16,0	4
E.9625.0.0900	26	9	8	85	25,0	4
E.9625.0.0950	27	-	8	85	25,0	4
E.9625.0.1000	28	10	8	85	25,0	4
E.9625.0.1050	31	10.5	10	90	25,0	4
E.9625.0.1200	34	12	10	90	25,0	4
E.9625.0.1400	44	14	16	100	25,0	6
E.9625.0.1500	46	15	16	100	25,0	6
E.9625.0.1600	48	16	16	100	25,0	6
E.9625.0.2000	56	20	16	112	32,0	6

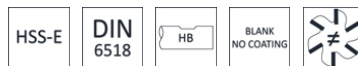

Individuelle Schnittdaten online im  
Schnittdaten-Rechner berechnen lassen:  
Calculate individual cutting  
data online in the cutting data calculator  
[www.nachreiner-schnittdaten.eu](http://www.nachreiner-schnittdaten.eu)

# PRODUKTDATENBLATT



Materialbezeichnung material description	Bearbeitung Process	Vc m/min	fz								
			∅ 8.00-9.00	∅ 10.00-11.00	∅ 12.00-15.00	∅ 16.00	∅ 20.00-23.00	∅ 24.00-27.00	∅ 28.00-31.00	∅ 34.00	
PA allg. Stähle General steels	Schlichten finishing	35.00	0.013	0.017	0.020	0.031	0.036	0.042	0.047	0.057	
	Schlichten finishing	30.00	0.013	0.017	0.020	0.031	0.036	0.042	0.047	0.057	
	Schlichten finishing	25.00	0.013	0.017	0.020	0.031	0.036	0.042	0.047	0.057	
	Schlichten finishing	20.00	0.013	0.017	0.020	0.031	0.036	0.042	0.047	0.057	
	Schlichten finishing	15.00	0.013	0.017	0.020	0.031	0.036	0.042	0.047	0.057	
PV Vergütungsstähle < 850N/mm <sup>2</sup> Tempering steel < 850N/mm <sup>2</sup>	Schlichten finishing	25.00	0.013	0.017	0.020	0.031	0.036	0.042	0.047	0.057	
	Schlichten finishing	20.00	0.013	0.017	0.020	0.031	0.036	0.042	0.047	0.057	
	Schlichten finishing	15.00	0.013	0.017	0.020	0.031	0.036	0.042	0.047	0.057	
K Gusseisen Cast iron	Schlichten finishing	35.00	0.013	0.017	0.020	0.031	0.036	0.042	0.047	0.057	
	Schlichten finishing	30.00	0.013	0.017	0.020	0.031	0.036	0.042	0.047	0.057	
	Schlichten finishing	25.00	0.013	0.017	0.020	0.031	0.036	0.042	0.047	0.057	
N AL- und AL-Legierungen AL and AL-alloys	Schlichten finishing	50.00	0.017	0.022	0.026	0.040	0.047	0.054	0.061	0.074	
	Schlichten finishing	40.00	0.017	0.022	0.026	0.040	0.047	0.054	0.061	0.074	
	Schlichten finishing	30.00	0.017	0.022	0.026	0.040	0.047	0.054	0.061	0.074	
S Titan Titanium	Schlichten finishing	10.00	0.009	0.012	0.014	0.022	0.025	0.029	0.033	0.040	