

HSSE-Viertelrund-Profilfräser, konkav

HSSE corner rounding profile cutters, concave

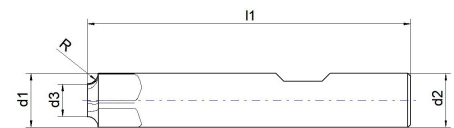

| Artikelnummer Article-No. | d1 js15 | R H11 | d3 | l1 | d2 h6 | flutes |
|------------------------------|---------|-------|----|-----|-------|--------|
| E.9625.0.0100 | 8 | 1 | 6 | 60 | 10,0 | 4 |
| E.9625.0.0150 | 9 | 1.5 | 6 | 60 | 10,0 | 4 |
| E.9625.0.0200 | 10 | 2 | 6 | 60 | 10,0 | 4 |
| E.9625.0.0250 | 11 | 2.5 | 6 | 60 | 10,0 | 4 |
| E.9625.0.0300 | 12 | 3 | 6 | 60 | 12,0 | 4 |
| E.9625.0.0350 | 13 | 3.5 | 6 | 60 | 12,0 | 4 |
| E.9625.0.0400 | 14 | 4 | 6 | 60 | 12,0 | 4 |
| E.9625.0.0450 | 15 | 4.5 | 6 | 60 | 12,0 | 4 |
| E.9625.0.0500 | 16 | 5 | 6 | 60 | 12,0 | 4 |
| E.9625.0.0600 | 20 | 6 | 8 | 67 | 16,0 | 4 |
| E.9625.0.0700 | 22 | 7 | 8 | 71 | 16,0 | 4 |
| E.9625.0.0750 | 23 | 7.5 | 8 | 71 | 16,0 | 4 |
| E.9625.0.0800 | 24 | 8 | 8 | 71 | 16,0 | 4 |
| E.9625.0.0900 | 26 | 9 | 8 | 85 | 25,0 | 4 |
| E.9625.0.0950 | 27 | - | 8 | 85 | 25,0 | 4 |
| E.9625.0.1000 | 28 | 10 | 8 | 85 | 25,0 | 4 |
| E.9625.0.1050 | 31 | 10.5 | 10 | 90 | 25,0 | 4 |
| E.9625.0.1200 | 34 | 12 | 10 | 90 | 25,0 | 4 |
| E.9625.0.1400 | 44 | 14 | 16 | 100 | 25,0 | 6 |
| E.9625.0.1500 | 46 | 15 | 16 | 100 | 25,0 | 6 |
| E.9625.0.1600 | 48 | 16 | 16 | 100 | 25,0 | 6 |
| E.9625.0.2000 | 56 | 20 | 16 | 112 | 32,0 | 6 |

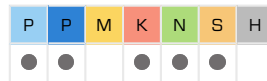
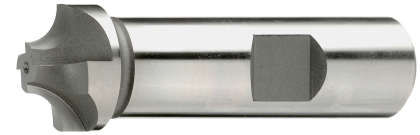

Individuelle Schnittdaten online im
Schnittdaten-Rechner berechnen lassen:
Calculate individual cutting
data online in the cutting data calculator
www.nachreiner-schnittdaten.eu

PRODUCT DATA SHEET



| Materialbezeichnung material description | Bearbeitung Process | Vc m/min | fz | | | | | | | | |
|---|-------------------------|-------------|----------------|------------------|------------------|------------|------------------|------------------|------------------|------------|--|
| | | | ∅ 8.00-9.00 | ∅ 10.00-11.00 | ∅ 12.00-15.00 | ∅ 16.00 | ∅ 20.00-23.00 | ∅ 24.00-27.00 | ∅ 28.00-31.00 | ∅ 34.00 | |
| PA allg. Stähle General steels | Schlichten finishing | 35.00 | 0.013 | 0.017 | 0.020 | 0.031 | 0.036 | 0.042 | 0.047 | 0.057 | |
| | Schlichten finishing | 30.00 | 0.013 | 0.017 | 0.020 | 0.031 | 0.036 | 0.042 | 0.047 | 0.057 | |
| | Schlichten finishing | 25.00 | 0.013 | 0.017 | 0.020 | 0.031 | 0.036 | 0.042 | 0.047 | 0.057 | |
| | Schlichten finishing | 20.00 | 0.013 | 0.017 | 0.020 | 0.031 | 0.036 | 0.042 | 0.047 | 0.057 | |
| | Schlichten finishing | 15.00 | 0.013 | 0.017 | 0.020 | 0.031 | 0.036 | 0.042 | 0.047 | 0.057 | |
| PV Vergütungsstähle < 850N/mm ² Tempering steel < 850N/mm ² | Schlichten finishing | 25.00 | 0.013 | 0.017 | 0.020 | 0.031 | 0.036 | 0.042 | 0.047 | 0.057 | |
| | Schlichten finishing | 20.00 | 0.013 | 0.017 | 0.020 | 0.031 | 0.036 | 0.042 | 0.047 | 0.057 | |
| | Schlichten finishing | 15.00 | 0.013 | 0.017 | 0.020 | 0.031 | 0.036 | 0.042 | 0.047 | 0.057 | |
| K Gusseisen Cast iron | Schlichten finishing | 35.00 | 0.013 | 0.017 | 0.020 | 0.031 | 0.036 | 0.042 | 0.047 | 0.057 | |
| | Schlichten finishing | 30.00 | 0.013 | 0.017 | 0.020 | 0.031 | 0.036 | 0.042 | 0.047 | 0.057 | |
| | Schlichten finishing | 25.00 | 0.013 | 0.017 | 0.020 | 0.031 | 0.036 | 0.042 | 0.047 | 0.057 | |
| N AL- und AL-Legierungen AL and AL-alloys | Schlichten finishing | 50.00 | 0.017 | 0.022 | 0.026 | 0.040 | 0.047 | 0.054 | 0.061 | 0.074 | |
| | Schlichten finishing | 40.00 | 0.017 | 0.022 | 0.026 | 0.040 | 0.047 | 0.054 | 0.061 | 0.074 | |
| | Schlichten finishing | 30.00 | 0.017 | 0.022 | 0.026 | 0.040 | 0.047 | 0.054 | 0.061 | 0.074 | |
| S Titan Titanium | Schlichten finishing | 10.00 | 0.009 | 0.012 | 0.014 | 0.022 | 0.025 | 0.029 | 0.033 | 0.040 | |